



CUSTOM REV™ SERIES CARBON FIBER DRIVESHAFT FORM

Meets SFI 43.1 specifications.

- 2000 HP / 1500 lb*ft Max
- 1350 U-Joints
- 3.2" or 3.7" Diameter
- 65" Maximum Length

STEP 1: Vehicle data:

Year, Make, Model: _____
 Weight: _____ Max Vehicle Speed: _____

STEP 2: Engine specifications:

Make: _____ Engine Displacement: _____
 Horsepower: _____ Torque: _____ Max RPM: _____

STEP 3: Driveline information:

Transmission Make & Model: _____
 High Gear Ratio: _____ Low Gear Ratio: _____ Number of Splines on Output Shaft:¹ _____
 Rear Differential Gear Ratio: _____ Rear Tire Size: _____
 Current Driveshaft O.D.: _____ Max O.D. of Driveshaft: _____ Min. Distance to Exhaust: _____

¹ Some transmission yokes have missing splines. If counting the yoke, add the missing spline(s) to get the correct count. If counting the transmission output shaft, it will always have the correct count and no splines will be missing.

STEP 4: Select a diameter: 3.2" (JJC-AC0320) 3.7" (JJC-AC0360)

STEP 5: Select a U-joint series, slip yoke and rear flange, if applicable.

1. Confirm the U-joint series, using the corresponding figure for dimensions:

Series	Joint Type	Cap Dia (D)	Width (E)	Cap Dia (F)	Width (G)
<input type="checkbox"/> 1350	Solid	1.188"	3.622"	1.188"	3.622"

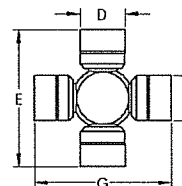

2. Choose a counter bored or full spline slip yoke option:

Counter Bored

- GM 27 - 1.503" O.D., 6.9" Long
- GM 32 - 1.886" O.D., 7.9" Long
- GM 32 - 1.886" O.D., 5.5" Long
- GM 32 - 1.888" O.D., 5.5" Long, Hardened **+\$100**
- Mopar 30 - 1.680" O.D., 6.1" Long

Full Spline

- GM 27 - 1.499" O.D., 5.5" Long, Hardened **+\$100**
- GM 27 - 1.503" O.D., 5.5" Long
- GM 32 - 1.886" O.D., 5.5" Long
- GM 32 - 1.886" O.D., 6.9" Long
- Ford 28 - 1.598" O.D., 6.6" Long (4R70W)
- Ford 28 - 1.499" O.D., 6.5" Long (C4, AOD, T5, T10)
- Ford 31 - 1.685" O.D., 6.4" Long

3. Choose a rear flange yoke option:

- 4 Bolt, 2.0" Female Pilot, 4.25" Bolt Hole Circle **+\$100**
- 4 Bolt, 2.95" Female Pilot, 4.75" Bolt Hole Circle **+\$100**
- 3 Bolt, 16mm Female Pilot, 10mm Bolt Hole Circle **+\$200**
- None

STEP 6: Certified to the SFI 43.1 Standard: Yes **+\$35** No

STEP 7: Driveshaft measurements taken with vehicle at ride height:

(Measure to within 1/16". Available in lengths up to 65".)

Center of front U-joint to center of rear U-joint (A)²: _____
 End of transmission tail housing to center of rear U-joint (B): _____
 End of output shaft to end of transmission tail housing (C): _____
 End of slip yoke to center of front U-joint (D): _____
 Center of front U-joint to end of flange yoke (E): _____

Detailed View
Minus the Driveshaft

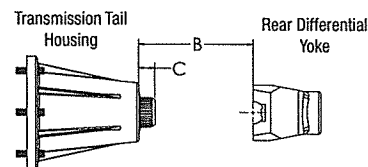

² Take this u-joint center-to-center measurement with the slip yoke in its operating position. The slip yoke operating position is typically determined by pulling the slip yoke out of the transmission 1" after it is fully bottomed out.

Driveshaft Assembly

Driveshaft Assembly with Rear Flange Yoke

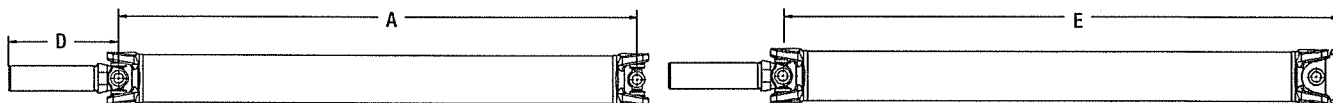

ORDER FORM



REV™ SERIES CARBON FIBER DRIVESHAFT ORDER FORM

PAYMENT & LEAD TIME

50% **non-refundable** deposit required on all custom driveshaft orders before production begins. The approximate lead time for a custom driveshaft is 2 weeks from receipt of completed order form, unless otherwise indicated in writing from QA1.

LEGAL DISCLAIMER NOTICE

This composite driveshaft product and related components are sold as-is without any warranty whatsoever, expressed or implied, including but not limited to any implied warranties of merchantability or fitness for a particular purpose. QA1 assumes no responsibility or liability for the selection, installation or any use of the products. The end user acknowledges that the product will be used for vehicles with not more than 2000 HP with max torque of 1500 lb*ft for driveshafts using 1350 Series U-joints and not more than 750 HP with max torque of 500 lb*ft for driveshafts using all other U-joints and assumes any and all risks related to such activities. The end user and any person who installs this product and related components are solely responsible for determination of the suitability of the product and components selected. The end user installs and uses the products and components at their own risk and agrees to fully indemnify QA1 against any claims, damages or losses resulting from the selection, installation or use of the products or related components.

Only experienced and qualified persons should install the products and components. Failure to properly install the product or related components may result in vehicle damage, personal injury or death.

QA1 IS NOT RESPONSIBLE FOR IMPROPER OR INCORRECT INFORMATION PROVIDED BY CUSTOMER.

ALL SALES FINAL.

Warning: Be sure to inspect all components regularly, especially following a crash. Do not use any components which may have been damaged.

Warning: If composite driveshaft is dropped or damaged, it should be taken out of service and replaced.

QUESTIONS?

For any questions, please contact QA1 at 800.721.7761 or 952.985.5675 to speak to a support specialist. Our office hours are Monday - Friday, 8 am - 5 pm CST.

SUBMITTING THE ORDER FORM

Please submit this completed order form to an authorized QA1 dealer or directly to QA1 via email at sales@qa1.net or via fax at 952.985.5679.

By signing below, I agree to the above disclaimer information and confirm that all information I have provided is accurate.

COMPLETED
BY BUYER

Signature: _____ Date: _____

Print Name: _____

Address: _____

City: _____ State: _____ Zip: _____

Email: _____ Phone: _____

COMPLETED
BY DEALER

QA1 Dealer Name: _____

Address: _____

City: _____ State: _____ Zip: _____

Email: _____ Phone: _____

Submitted to QA1 by: _____ Date: _____