

40-613-1

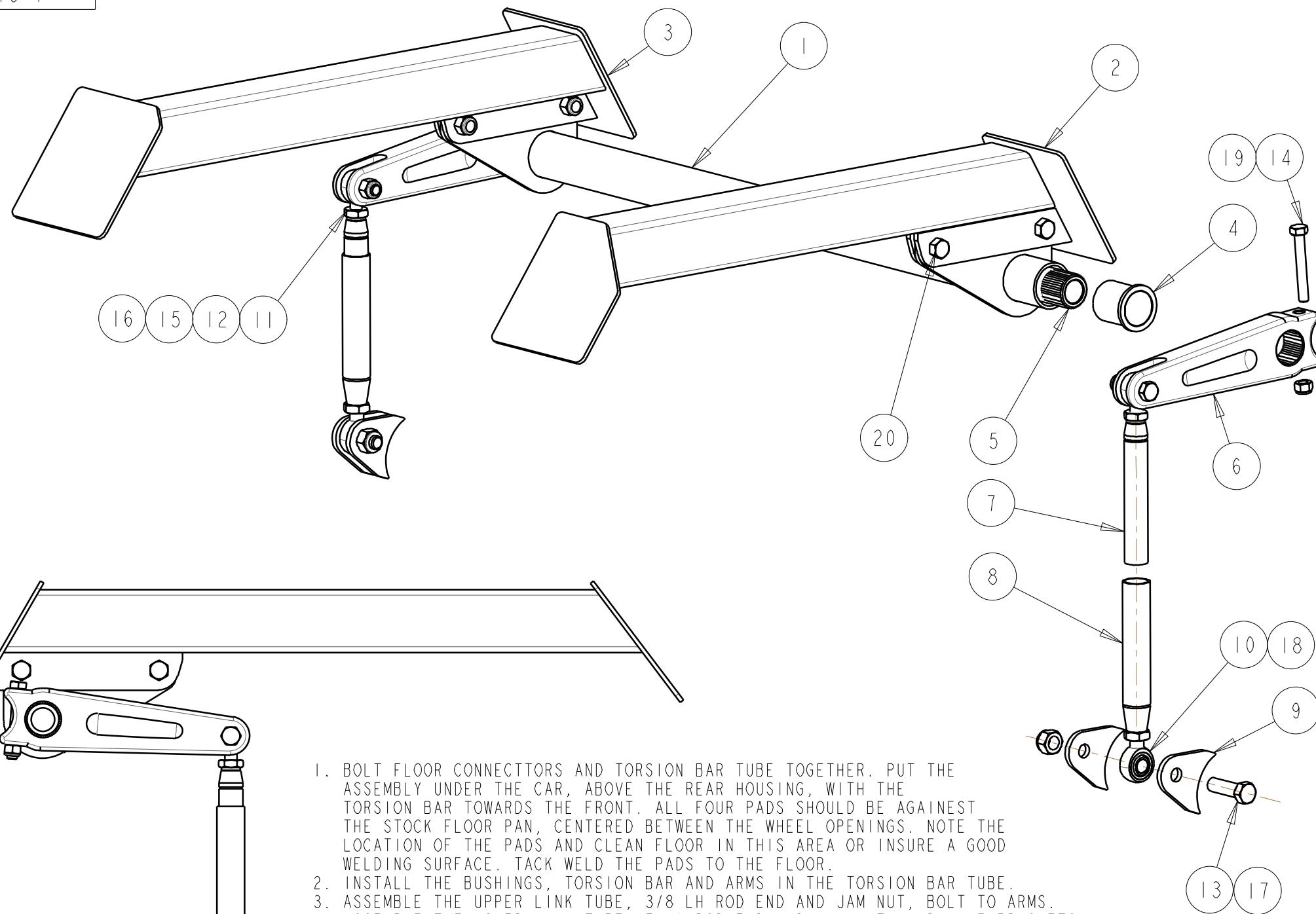

1. BOLT FLOOR CONNECTORS AND TORSION BAR TUBE TOGETHER. PUT THE ASSEMBLY UNDER THE CAR, ABOVE THE REAR HOUSING, WITH THE TORSION BAR TOWARDS THE FRONT. ALL FOUR PADS SHOULD BE AGAINST THE STOCK FLOOR PAN, CENTERED BETWEEN THE WHEEL OPENINGS. NOTE THE LOCATION OF THE PADS AND CLEAN FLOOR IN THIS AREA OR INSURE A GOOD WELDING SURFACE. TACK WELD THE PADS TO THE FLOOR.
2. INSTALL THE BUSHINGS, TORSION BAR AND ARMS IN THE TORSION BAR TUBE.
3. ASSEMBLE THE UPPER LINK TUBE, 3/8 LH ROD END AND JAM NUT, BOLT TO ARMS.
4. ASSEMBLE THE LOWER LINK TUBE, 7/16 ROD END AND JAM NUT, AND AXLE BRACKETS.
5. DUE TO VARIATIONS IN TIRE SIZE, SPRING RATES AND RIDE HEIGHT THE UPPER AND LOWER LINK TUBE LENGTH HAS TO BE DETERMINE FOR YOUR COMBINATION. THE REAR AXLE HAS TO BE AT RIDE HEIGHT WITH RESPECT TO THE BODY TO GET THE CORRECT LENGTH. SLIP THE LOWER LINK TUBE OVER THE UPPER LINK TUBE. PUT THE AXLE BRACKETS AGAINST THE AXLE TUBE. THE TORSION BAR ARM SHOULD BE ANGLED DOWN SLIGHTLY AND THE BRACKETS SHOULD BE ROTATED UP ON THE AXLE TUBES SLIGHTLY TO ALLOW CLEARENCE BETWEEN THE JAM NUTS, BRACKETS AND ARMS AS THE SUSPENSION MOVES. TACK WELD THE BRACKETS TO THE AXLE TUBE AND THE UPPER LINK TUBE TO THE LOWER LINK TUBE.
6. MOVE THE SUSPENSION THROUGH ITS FULL TRAVEL AND CHECK THAT THE COMPONENTS DO NOT BIND OR HIT ANYTHING.
7. CHECK YOUR WORK, AND FINISH WELDING ALL OF THE COMPONENTS.

DRIVERS SIDE VIEW
SCALE 0.250

S & W RACE CARS
11 MENNONITE CHURCH RD
SPRING CITY, PA 19475

BILL OF MATERIALS

| ITEM | QTY | PART No. | DESCRIPTION |
|------|-----|-----------|-----------------------|
| 1 | 1 | 40-613-01 | TORSION TUBE WELDMENT |
| 2 | 1 | 40-613-02 | RIGHT FLOOR CONNECTOR |
| 3 | 1 | 40-613-03 | LEFT FLOOR CONNECTOR |
| 4 | 2 | 40-902 | TORSION BAR BUSHING |
| 5 | 1 | 40-900-29 | TORSION BAR |
| 6 | 2 | 05-015 | TORSION ARM |
| 7 | 2 | 40-613-04 | TOP LINK TUBE |
| 8 | 2 | 40-613-05 | BTM LINK TUBE |
| 9 | 4 | 40-613-05 | AXLE TAB |
| 10 | 2 | 64-107 | 7/16 ROD END |
| 11 | 2 | 64-306 | 3/8 LH ROD END |
| 12 | 2 | 65-026 | 3/8 X 1 1/2" BOLT |
| 13 | 2 | 65-036 | 7/16 X 1 1/2" BOLT |
| 14 | 2 | 65-078 | 5/16 X 2 1/4" BOLT |
| 15 | 6 | 65-132 | 3/8 NYLOCK NUT |
| 16 | 2 | 65-113 | 3/8 JAM NUT |
| 17 | 2 | 65-134 | 7/16 NYLOCK NUT |
| 18 | 2 | 65-114 | 7/16 JAM NUT |
| 19 | 2 | 65-131 | 5/16 NYLOCK NUT |
| 20 | 4 | 65-024 | 3/8 X 1" BOLT |

| A | 08JUN05 | JEB | CORRECTED P/N OF ITEM #16 |
|---|---------|-----------------|---|
| 0 | 05APR04 | JEB | INITIAL RELEASE |
| REV | DATE | DRN | DESCRIPTION |
| TOLERANCES: FRACTIONS ±1/32 2 PLC DEC ±0.01 3 PLC DEC ±0.005 ANGLES ±0.5° | | | CAMARO BOLT ON TORSION BAR GENERAL ARR'G'T |
| MAT'L: | | | |
| SCALE 0.250 | | PART No: 40-613 | |
| | | | DRW No: 40-613 - 1 |