

10-810-1

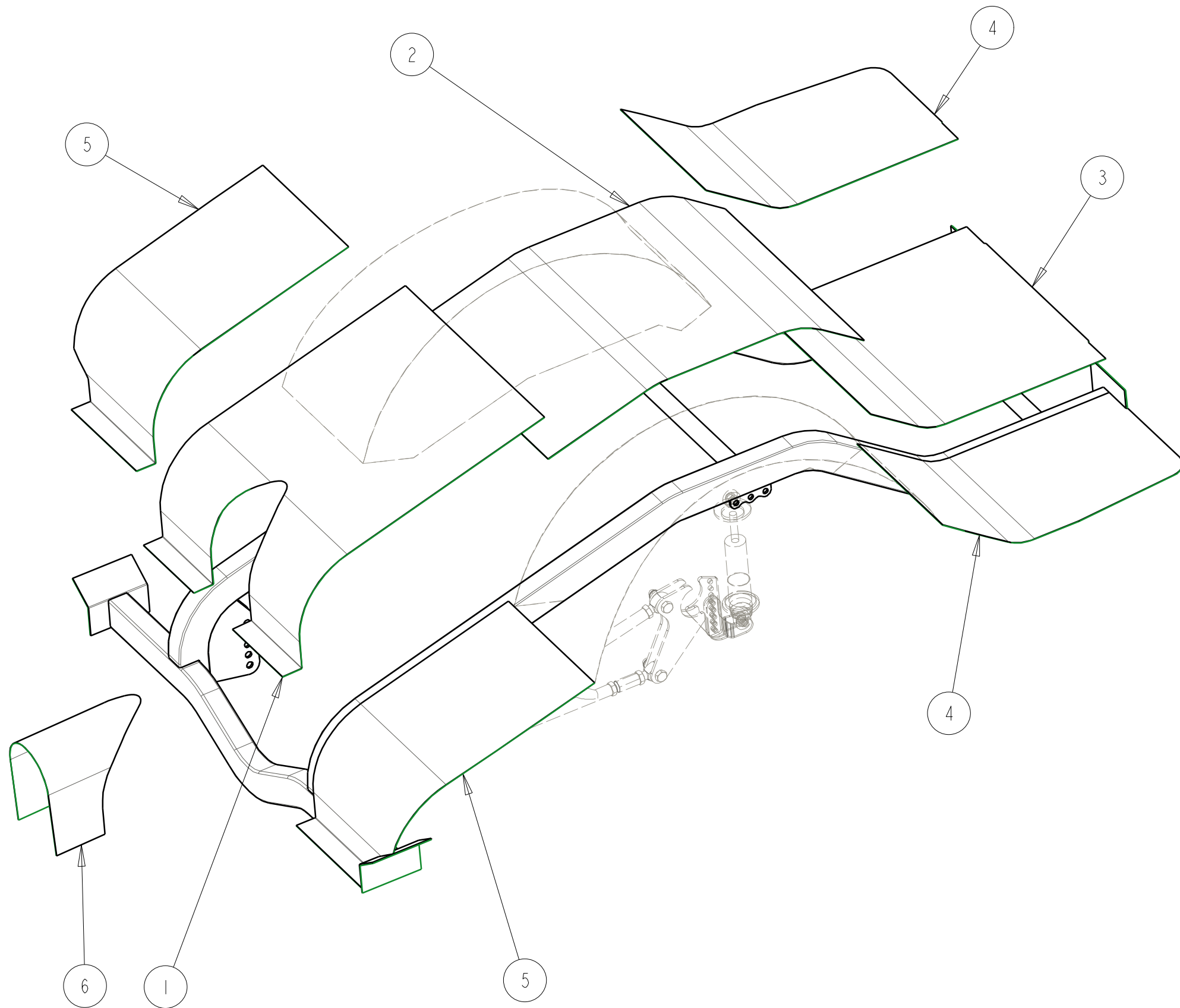

BILL OF MATERIALS

ITEM	QTY	PART No.	DESCRIPTION
1	1	10-810-03	FLOOR PANEL - CENTER FRONT
2	1	10-810-02	FLOOR PANEL - CENTER MID
3	1	10-800-01	FLOOR PANEL - CENTER REAR
4	2	10-800-05	FLOOR PANEL - OUTSIDE REAR
5	2	10-810-04	FLOOR PANEL - OUTSIDE FRONT
6	1	10-800-6	DRIVE SHAFT TUNNEL

INSTALLATION NOTES:

THIS KIT IS TO BE INSTALLED AFTER THE FRAME & WHEEL TUBES ARE IN THE CAR. DO NOT PERMANENTLY FASTEN ANY OF THE PANELS UNTIL ALL OF THEM HAVE BEEN TRIMMED FOR THE FINAL FIT.

1. USING A STRAIGHT EDGE TRACE THE CONTOUR OF THE TOP OF THE FRAME RAILS ON THE INSIDE OF THE BODY. MAKE CARDBOARD TEMPLATES TO MATCH THE CONTOUR OF THE BODY.
2. INSTALL THE FOUR OUTER PANELS. THESE PANEL SIT ON TOP OF THE RAILS WITH THE EDGE ABOUT 3/4" IN FROM THE OUTSIDE OF THE RAIL. USE THE TEMPLATES TO TRIM THE OUTER EDGES OF THE PANELS TO MATCH THE CONTOUR OF THE BODY.
3. TRIM THE CENTER REAR PANEL TO FIT AGAINST THE REAR TRUNK PANEL. THE FRONT OF THE PANEL IS LONG ENOUGH TO OVER LAP THE FRONT CENTER PANEL.
4. TEMPORARILY INSTALL THE CENTER FRONT PANEL AND TRIM THE TRANS TUNNEL SECTION TO FIT. MARK THE TUNNEL OPENING ON THE CENTER FRONT PANEL. CUT OUT AN OPENING IN THE PANEL BEING SURE TO LEAVE ENOUGH MATERIAL SO THE TUNNEL SECTION CAN BE FASTENED TO IT.

0	07FEB11	JEB	INITIAL RELEASE
REV	DATE	DRN	DESCRIPTION
TOLERANCES: FRACTIONS ±1/32 2 PLC DEC ±0.01 3 PLC DEC ±0.005 ANGLES ±0.5°			FLOOR KIT 10-810 & 10-811 NOVA LADDER BAR FRAME GENERAL ARRANGEMENT
MAT'L:			
			DRW No: 10-810 - 1

S & W RACE CARS
 11 MENNONITE CHURCH RD
 SPRING CITY, PA 19475