

**INSTALLATION INSTRUCTIONS**

1. RAISE AND SUPPORT CAR. SUPPORT REAR HOUSING SO THAT IT CAN NOT ROTATE WHEN STOCK TORQUE ARM IS REMOVED. THIS CAN BE DONE BY PLACING A JACK STAND UNDER THE PAN HARD BAR MOUNT ON THE REAR HOUSING.
2. REMOVE STOCK TORQUE ARM.
3. INSTALL ASSEMBLED TORQUE ARM, REAR BRACKET AND FRONT LINK.
4. ATTACH BOTTOM OF FRONT LINK TO S & W CROSSMEMBER USING THE 1/2 X 3" BOLT PROVIDED.
5. USE THE TORQUE ARM ADJUSTER (ITEM 4) TO SET THE PINION ANGLE. S & W RECOMMENDS THAT THE PINION BE POINTED DIRECTLY AT THE TAIL SHAFT OF THE TRANSMISSION OR SLIGHTLY BELOW. PINION ANGLE MUST BE SET WITH CAR AT RIDE HEIGHT.
6. WHEN THE PINION ANGLE IS SET TIGHTEN ALL JAM NUTS AND REAR BRACKET NUTS. THE FRONT LINK MUST BE FREE TO PIVOT, DO NOT OVER TIGHTEN.

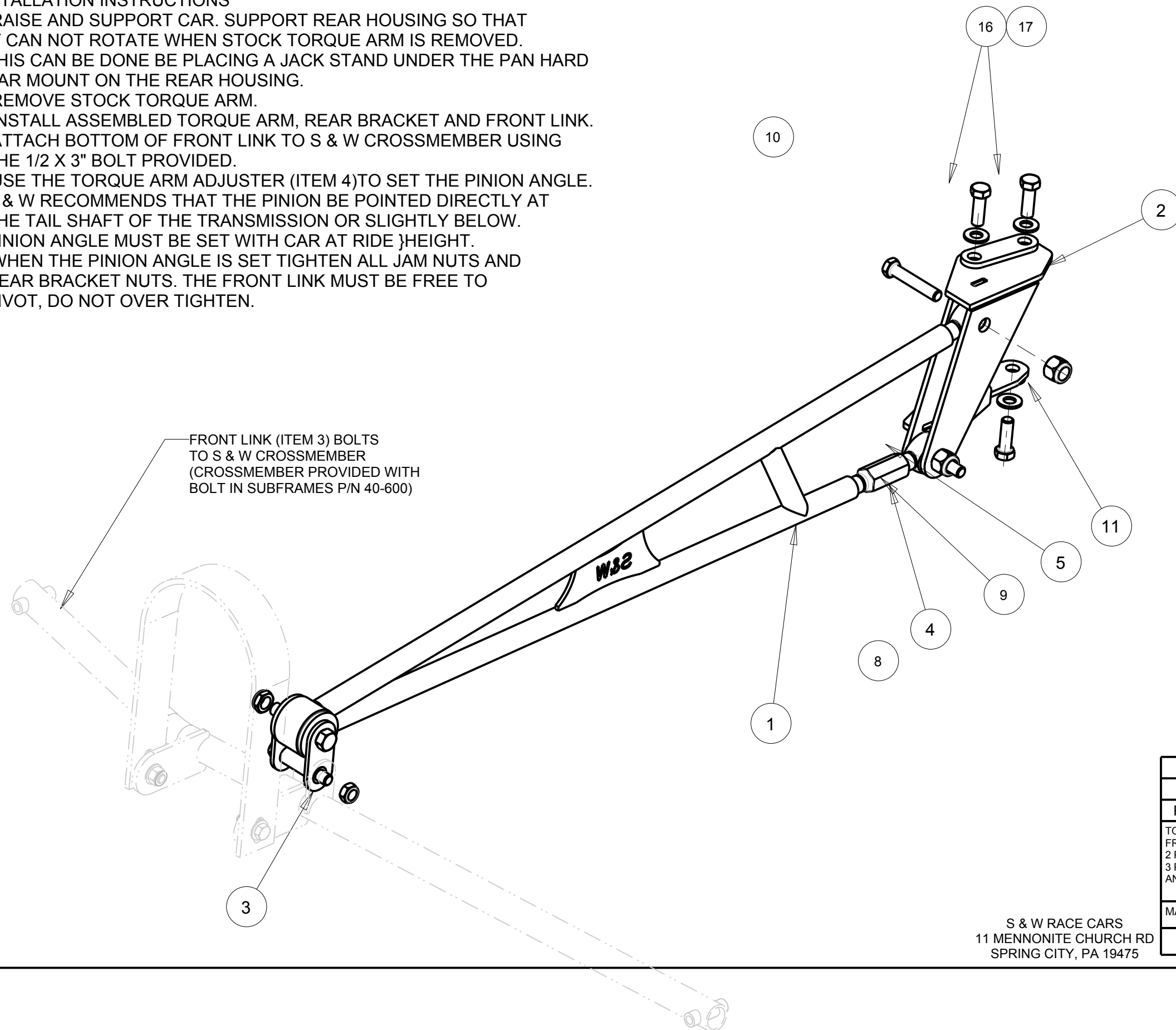

FRONT LINK (ITEM 3) BOLTS TO S & W CROSSMEMBER (CROSSMEMBER PROVIDED WITH BOLT IN SUBFRAMES P/N 40-600)

BILL OF MATERIALS			
ITEM	QTY	PART No.	DESCRIPTION
1	1	40-601-01	TORQUE ARM ASS'Y
2	1	40-601-02	REAR BRACKET ASS'Y
3	1	40-601-03	FRONT LINK ASS'Y
4	1	65-1001	TORQUE ARM ADJUSTER
5	2	40-235	SOLID ROD END
6	2	40-603-03	POLY BUSHING
7	1	40-603-04	STEEL SLEEVE
8	1	65-121	3/4 JAM NUT, LH THD
9	2	65-120	3/4 JAM NUT, RH THD
10	2	65-310	5/8 X 2 1/2" BOLT
11	2	65-140	5/8 NYLOCK
12	1	65-067	9/16 X 3" BOLT
13	1	65-151	9/16 JAM NYLOCK
14	1	65-050	1/2 X 3 BOLT
15	1	65-145	1/2 JAM NYLOCK
16	4	65-706	1/2-13 x 1-1/2" BOLT
17	4	65-204	1/2" FLAT WASHER

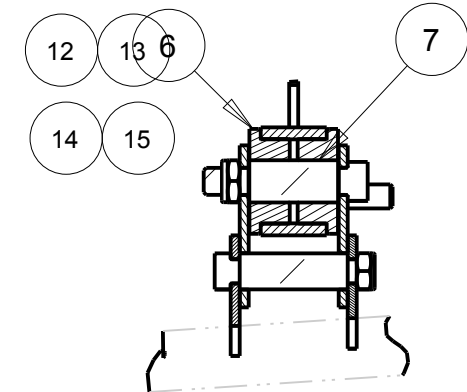

SECTION A-A  
SCALE 0.250

0	15MAY09	JEB	INITIAL RELEASE
REV	DATE	DRN	DESCRIPTION
TOLERANCES: FRACTIONS ±1/32 2 PLC DEC ±0.01 3 PLC DEC ±0.005 ANGLES ±0.5°			ADJUSTABLE TORQUE ARM 82-92 CAMARO/FIREBIRD (4-BOLT)
MAT'L:			
PART No: 40-606			DRW No: 40-601 - 2

S & W RACE CARS  
11 MENNONITE CHURCH RD  
SPRING CITY, PA 19475