

40-623-1

NOTE:  
1. SET INITIAL LENGTH THE SAME  
AS STOCK CONTROL ARMS (19-1/4").

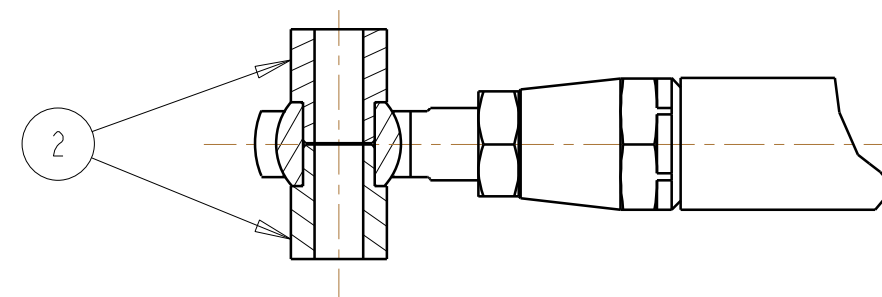
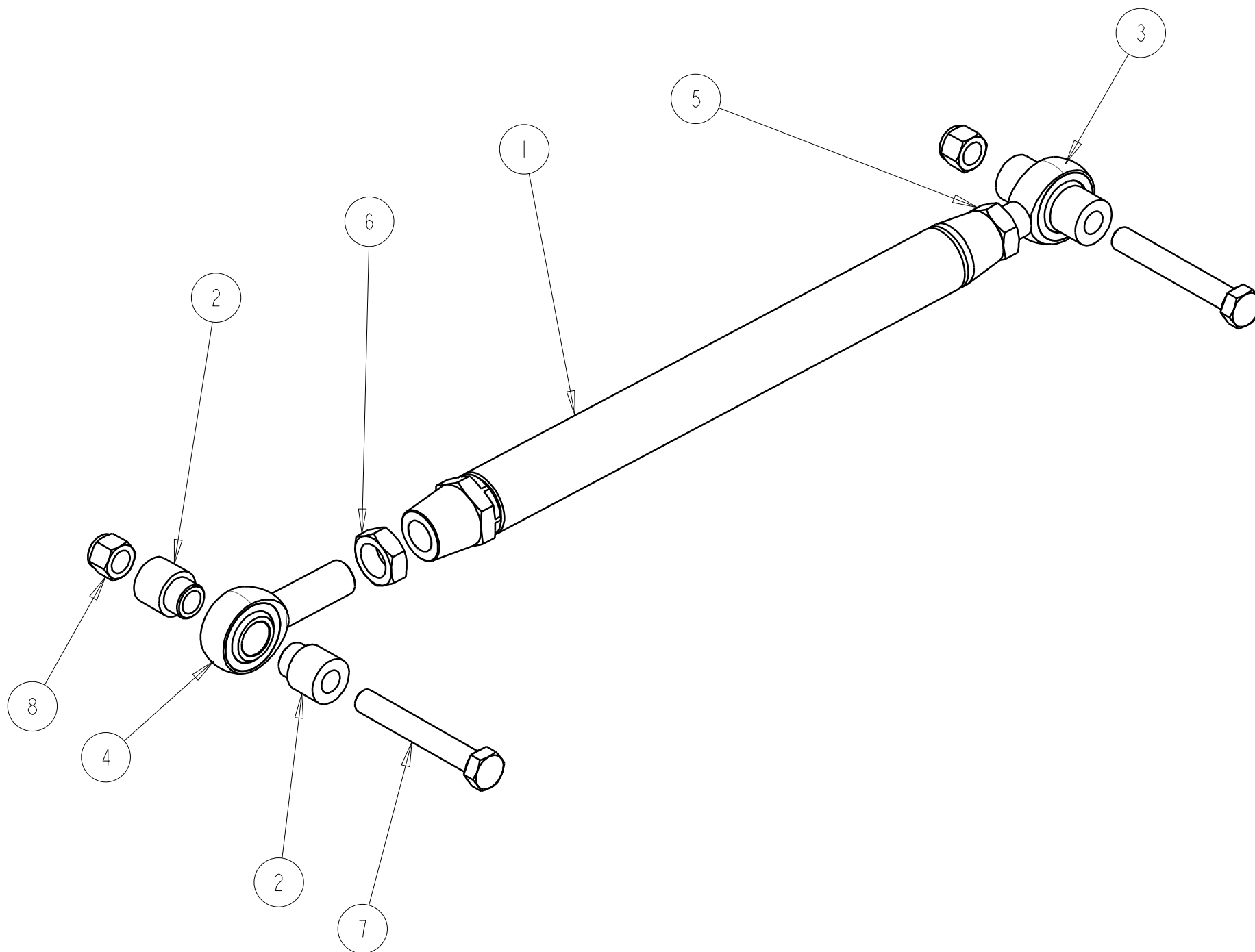

BILL OF MATERIALS

ITEM	QTY	PART No.	DESCRIPTION
1	2	40-623-01	CONTROL ARM WELDMENT
2	8	40-723-03	SPACER-BUSHONG
3	2	64-212	3/4" ROD END
4	2	64-412	3/4" LH ROD END
5	2	65-120	3/4 JAM NUT
6	2	65-121	3/4 LH JAM NUT
7	4	65-051	1/2 X 3 1/2" LG BOLT
8	4	65-135	1/2 NYLOCK NUT

0	14APR10	JEB	INITIAL RELEASE
REV	DATE	DRN	DESCRIPTION
TOLERANCES: FRACTIONS ±1/32 2 PLC DEC ±0.01 3 PLC DEC ±0.005 ANGLES ±0.5°			F-BODY / G-BODY LOWER CONT ARM GENERAL ARRANGEMENT
MAT'L:			
PART No: 40-623			DRW No: 40-623 - 1

S & W RACE CARS  
11 MENNONITE CHURCH RD  
SPRING CITY, PA 19475