

40-700-1

NOTE:

1. JACK UP THE CAR AND SUPPORT WITH JACK STANDS SO THAT THE REAR HOUSING IS HANGING AND NOT SUPPORTING ANY OF THE CARS WEIGHT.

2. THE OEM RUBBER CURTAINS BOLTED TO BOTTOM OF CAR MUST BE REMOVED TO INSTALL THE S & W TORQUE BOX SUBFRAME CONNECTORS. TWO OF THE OEM BOLTS ARE USED TO BOLT THE CONNECTORS TO THE SUBFRAME.

3. REMOVE ONE LOWER CONTROL ARM AND INSTALL THE TORQUE BOX SUBFRAME CONNECTOR ON THAT SIDE. REPLACE THE FIRST CONTROL ARM BEFORE REMOVING THE OTHER CONTROL ARM AND STARTING THE INSTALLATION OF THE SECOND CONNECTOR.
CAUTION: THE REAR HOUSING MAY MOVE WHEN THE CONTROL ARM IS REMOVED.

4. S & W RECOMMENDS USING LOCK TIGHT OR A SIMILAR PRODUCT ON ALL BOLTS WITH OUT NYLOCKS.

5. THE EMERGENCY BRAKE BRACKETS BOLTED TO THE STOCK TORQUE BOX WILL HAVE TO BE REMOVED. AFTER INSTALLATION OF THE CONNECTORS TIE WRAP THE EMERGENCY BRAKE CABLE TO ONE OF THE TUBES ON THE CONNECTORS.

BILL OF MATERIALS

ITEM	QTY	PART No.	DESCRIPTION
1	1	40-700-L	LT TORQ BOX SUBFRAME CONN
2	1	40-700-R	RT TORQ BOX SUBFRAME CONN
3	2	65-602	9/16 X 3 1/2" LG BOLT
4	2	65-603	9/16 NYLOCK NUT
5	4	65-330	3/8-16 X 1" BOLT
6	6	65-202	3/8 FLAT WASHER
7	6	65-212	3/8 LOCK WASHER

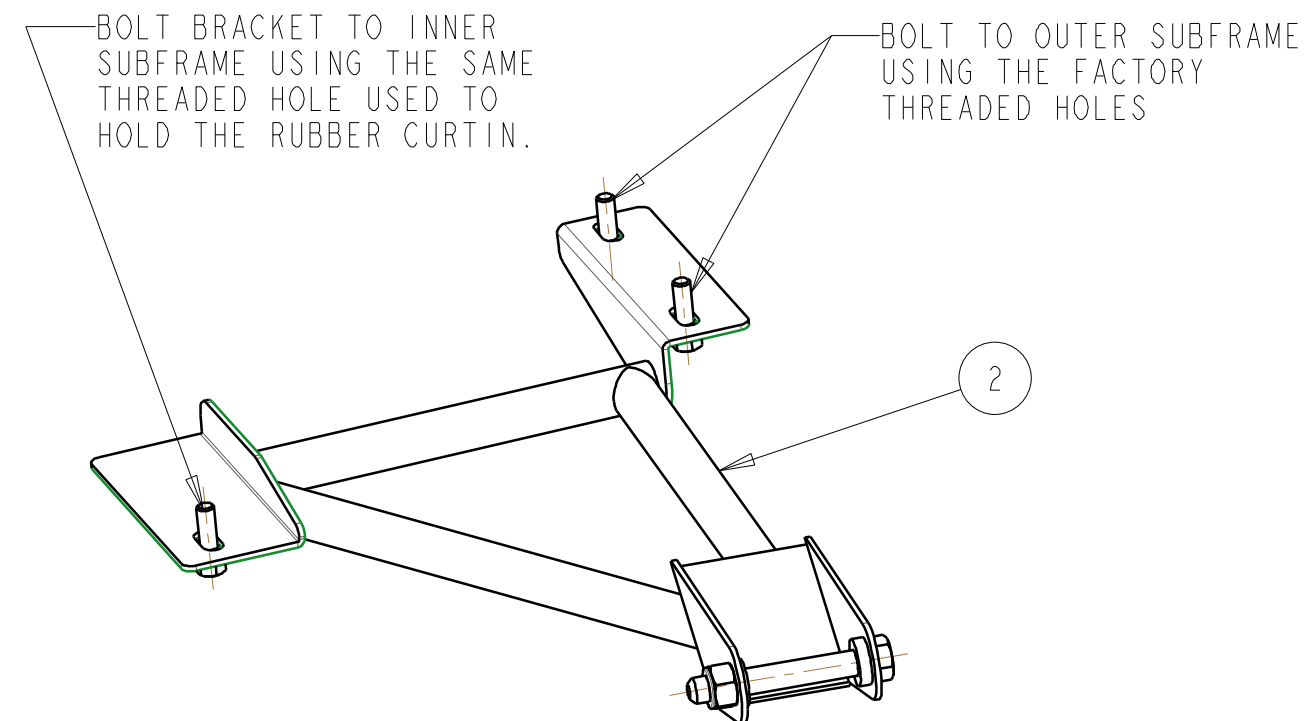
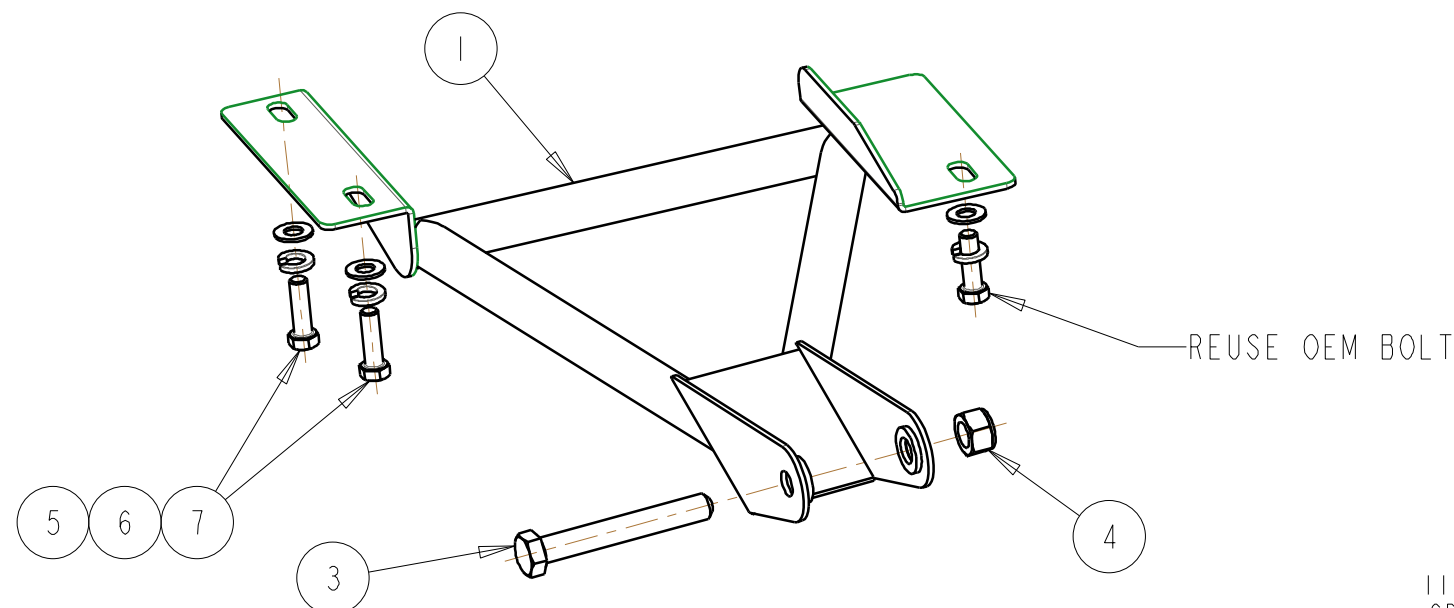

0	11DEC06	JEB	INITIAL RELEASE
REV	DATE	DRN	DESCRIPTION
TOLERANCES: FRACTIONS ±1/32 2 PLC DEC ±0.01 3 PLC DEC ±0.005 ANGLES ±0.5°			SUBFRAME TORQ BOX CONNECTORS GENERAL ARRANGEMENT
MAT'L: prt.material			
PART No: 40-700			DRW No: 40-700 - 1

S & W RACE CARS
11 MENNONITE CHURCH RD
SPRING CITY, PA 19475