

40-723-1

BILL OF MATERIALS

ITEM	QTY	PART No	DESCRIPTION
1	2	40-723-01	CONTROL ARM U-BRKT
2	4	40-723-02	ALUM BUSHING
3	2	750X120X1.50	BUSHING
4	4	40-723-03	SPACER / BUSHING
5	2	65-1001	HEX ADJUSTER, LADDER BAR
6	2	64-212	3/4" ROD END
7	1	65-120	3/4 RH JAM NUT
8	2	65-049	1/2 X 2 1/2" LG BOLT
9	2	65-051	1/2 X 3 1/2" LG BOLT
10	4	65-135	1/2 NYLOCK NUT
11	1	65-121	3/4 LH JAM NUT

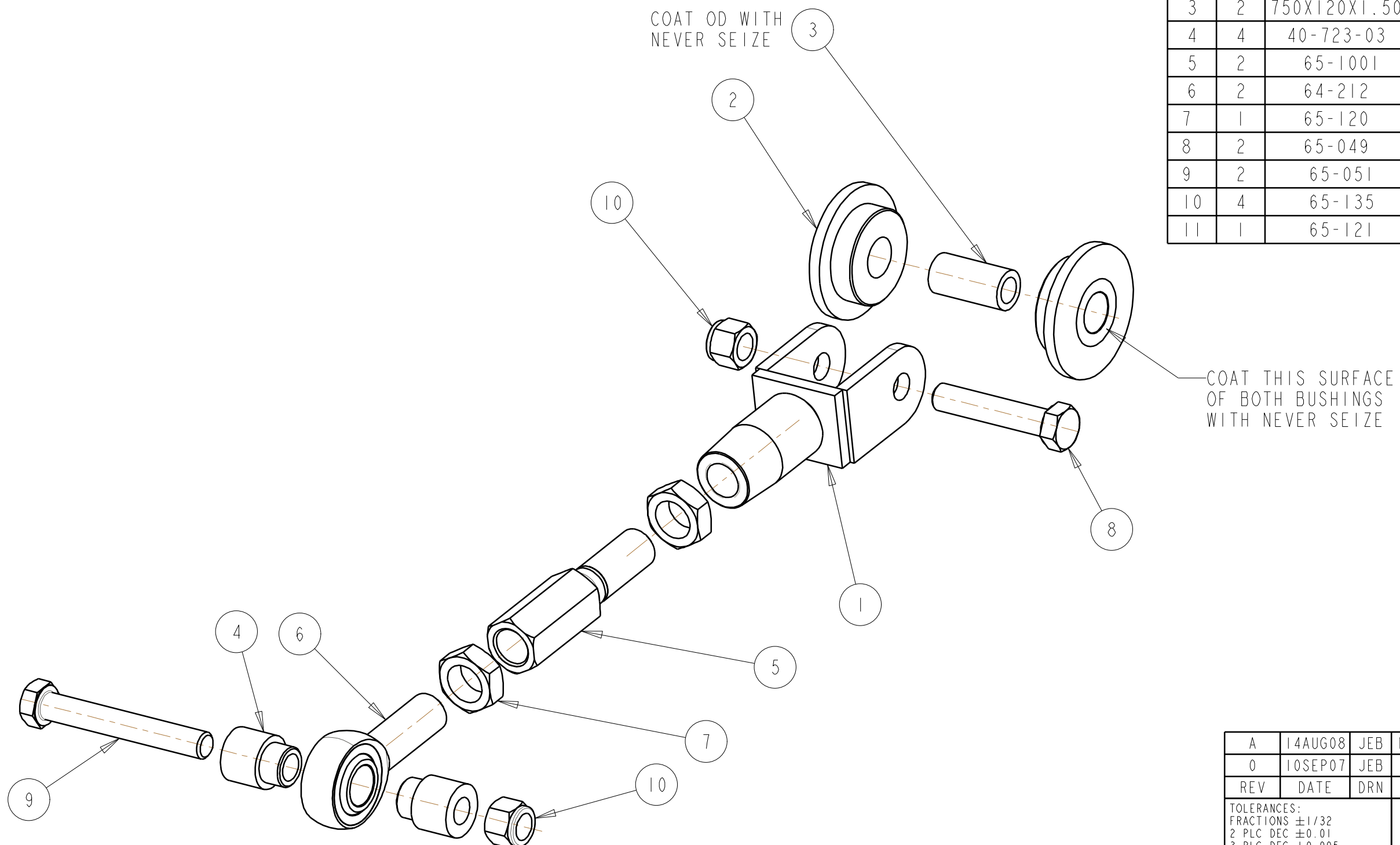

A	14AUG08	JEB	MOVED NOTES TO SHEET 2
0	10SEP07	JEB	INITIAL RELEASE
REV	DATE	DRN	DESCRIPTION
TOLERANCES: FRACTIONS ±1/32 2 PLC DEC ±0.01 3 PLC DEC ±0.005 ANGLES ±0.5°			ADJUSTABLE UPPER CONTROL ARM 79-04 MUSTANG GENERAL ARR'G'T
MAT'L:			
PART No: 40-723			DRW No: 40-723 - 1

S & W RACE CARS
11 MENNONITE CHURCH RD
SPRING CITY, PA 19475

INSTALLATION INSTRUCTIONS

1. RAISE THE CAR AND SUPPORT THE FRAME AND REAR HOUSING SO THAT THEY DO NOT MOVE WHEN THE CONTROLL ARMS ARE REMOVED.
2. REMOVE & INSTALL ONE UPPER CONTROLL ARM AT A TIME. REMOVE ONE CONTROLL ARM. REMOVE THE UPPER CONTROLL ARM BUSHING AND STEEL SLEEVE FROM THE REAR HOUSING. THE BUSHING AND SLEEVE WILL NOT BE REUSED.
3. ASSEMBLE THE U-BRACKET, HEX ADJUSTER, ROD END & JAM NUTS. THE LENGTH OF THE NEW CONTROL ARM SHOULD BE THE SAME AS THE STOCK ARM (9 3/8" ON CENTERS). DO NOT TIGHTEN JAM NUTS AT THIS POINT.
4. INSTALL THE NEW ALUMINUM BUSHINGS INTO THE LUGS ON THE REAR HOUSING. INSERT STEEL SLEEVES INTO THE ALUMINUM BUSHINGS. PUT A SMALL AMOUNT OF NEVER SEIZE ON THE OD OF THE STEEL SLEEVE AND THE OUTER FACE OF THE ALUMINUM BUSHINGS.
5. INSTALL THE NEW UPPER CONTROLL ARM. BOLT THE U-BRACKET TO THE REAR HOUSING. INSERT A SPACER BUSHING INTO EACH SIDE OF THE FRONT ROD END. SWING THE CONTROL ARM INTO PLACE. YOU MAY HAVE TO ADJUST THE LENGTH OR JACK THE REAR UP SLIGHTLY TO GET THE BOLT IN. DO NOT TIGHTEN THE BOLTS AT THIS TIME.
6. REPEAT THE ABOVE STEPS FOR THE OTHER SIDE.
7. WITH THE CAR AT RIDE HEIGHT AND ALL OF THE WEIGHT SUPPORTED BY THE SUSPENSION CHECK THE PINION ANGLE. PINION ANGLE SHOULD BE 0° - 1 1/2° DOWN. TO ADJUST PINION ANGLE REMOVE ONE OF THE U-BRACKET BOLTS AND TURN THE HEX ADJUSTER ON THE OTHER CONTROL ARM. TIGHTEN THE JAM NUTS ON THE ARM YOU ADJUSTED. ADJUST THE OTHER LINK AND BOLT IT IN. TIGHTEN THE JAM NUTS. TIGHTEN THE FRONT AND REAR NUTS & BOLTS OF BOTH CONTROL ARMS.

0	14AUG08	jeb	INITIAL RELEASE
REV	DATE	DRN	DESCRIPTION
TOLERANCES: FRACTIONS ±1/32 2 PLC DEC ±0.01 3 PLC DEC ±0.005 ANGLES ±0.5°			ADJUSTABLE UPPER CONTROL ARM 79-04 MUSTANG INSTALLATION NOTES
MAT'L:			
S & W RACE CARS 11 MENNONITE CHURCH RD SPRING CITY, PA 19475			PART No: 40-723
			DRW No: 40-723 - 2